

## Indicazioni di montaggio / Mounting Indication

<http://www.masteritaly.com>



**ACCESSORI PER SERRAMENTI PROGETTATI PER DURARE**  
FASTENING ACCESSORIES PLANNED TO LAST

# WiCloud

Attuatore per Vasistas - Art. **1121A.2**  
Actuator for Vasistas - Art. **1121A.2**

Per sistemi Camera Europea / For eurogroove system

## 24V

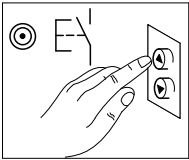

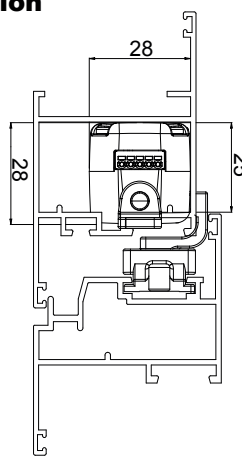

Le dimensioni dell'attuatore e della serratura automatica permettono il montaggio solo su infissi con telaio maggiorato o con una tubolarità tale da poter contenere gli ingombri indicati nell'immagine.

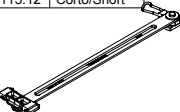
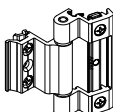
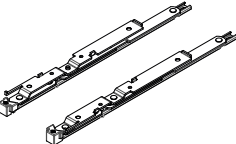

The dimensions of the actuator and of the automatic lock permit the installation only on enlarged profiles or on tubular profiles that can comply with the dimensions indicated in the picture.

## Altri Accessori / Other accessories

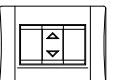
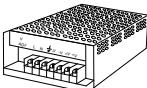
| <p><b>1115.X*</b></p> <table border="1"> <tr> <th>Art.</th> <th>Lungo/Long</th> </tr> <tr> <td>1115.1</td> <td>Corto/Short</td> </tr> <tr> <td>1115.11</td> <td>Lungo/Long</td> </tr> <tr> <td>1115.12</td> <td>Corto/Short</td> </tr> </table>  <ul style="list-style-type: none"> <li><b>IT</b> SIMPLE PLUS (limitatore di apertura)</li> <li><b>EN</b> SIMPLE PLUS (opening limiter)</li> <li><b>FR</b> SIMPLE PLUS (limiteur d'ouverture)</li> <li><b>ES</b> SIMPLE PLUS (compas limitador de apertura)</li> </ul> <p><b>OBBLIGATORIO IN ABBINAMENTO CON LE 3420.71</b><br/><b>REQUIRED IN COMBINATION WITH 3420.71</b></p> | Art.   | Lungo/Long | 1115.1 | Corto/Short | 1115.11 | Lungo/Long | 1115.12 | Corto/Short | <p><b>3420.71</b></p>  <ul style="list-style-type: none"> <li><b>IT</b> CERNIERA A PETTINE</li> <li><b>EN</b> COMB HINGE</li> <li><b>FR</b> PAUMELLE A PEIGNE</li> <li><b>ES</b> BISAGRAS DE TRES ALAS</li> </ul> |       |
|---|--|------------|--------|-------------|---------|------------|---------|-------------|--|-------|
| Art.  | Lungo/Long   |            |        |             |         |            |         |             |  |       |
| 1115.1  | Corto/Short  |            |        |             |         |            |         |             |  |       |
| 1115.11   | Lungo/Long   |            |        |             |         |            |         |             |  |       |
| 1115.12   | Corto/Short  |            |        |             |         |            |         |             |  |       |
| <p><b>1231.12</b></p>  <ul style="list-style-type: none"> <li><b>IT</b> EASY RAPID (cerniera a compasso 12")</li> <li><b>EN</b> EASY RAPID (stay hinge 12")</li> <li><b>FR</b> EASY RAPID (compas ouverture ext. 12")</li> <li><b>ES</b> EASY RAPID (compas proyectante ext. 12")</li> </ul>   | <p><b>1233.16</b></p>  <ul style="list-style-type: none"> <li><b>IT</b> EASY RAPID PLUS (cerniera a compasso 16")</li> <li><b>EN</b> EASY RAPID PLUS (stay hinge 16")</li> <li><b>FR</b> EASY RAPID PLUS (compas ouverture ext. 16")</li> <li><b>ES</b> EASY RAPID PLUS (compas proyectante ext. 16")</li> </ul>   |            |        |             |         |            |         |             |  |       |
| <p><b>1121.60</b></p>  <ul style="list-style-type: none"> <li><b>IT</b> Kit pulsante</li> <li><b>EN</b> Wall switch</li> <li><b>FR</b> Commutateur mural</li> <li><b>ES</b> Interruptor de pared</li> </ul>  | <p><b>1121.61/.62</b></p> <table border="1"> <tr> <th>Art.</th> <th>W</th> <th>A</th> </tr> <tr> <td>1121.61</td> <td>100 W</td> <td>4,2 A</td> </tr> <tr> <td>1121.62</td> <td>200 W</td> <td>8,4 A</td> </tr> </table>  <ul style="list-style-type: none"> <li><b>IT</b> Trasformatore 230V - 24V</li> <li><b>EN</b> Driver switch 230V - 24V</li> <li><b>FR</b> Transformateur de tension 230V - 24V</li> <li><b>ES</b> Transformador de voltaje 230V - 24V</li> </ul> | Art.       | W      | A           | 1121.61 | 100 W      | 4,2 A   | 1121.62     | 200 W  | 8,4 A |
| Art.  | W  | A          |        |             |         |            |         |             |  |       |
| 1121.61   | 100 W  | 4,2 A      |        |             |         |            |         |             |  |       |
| 1121.62   | 200 W  | 8,4 A      |        |             |         |            |         |             |  |       |

Per le portate dell'infisso fare riferimento alle indicazioni riguardati gli accessori sopra indicati che si decide di utilizzare.  
For window load capacity, refer to indications on the above-mentioned accessories that you decide to use.

\* Il SIMPLE PLUS deve sempre essere libero dal suo riscontro di battuta anche quando l'anta è al massimo della sua apertura.  
Questo articolo funge solo da sicurezza nel caso di rottura catena.

The SIMPLE PLUS should always be free from its abutment even when the 'door is at its maximum aperture.  
This article only serves as a safety in case of chain breakage.

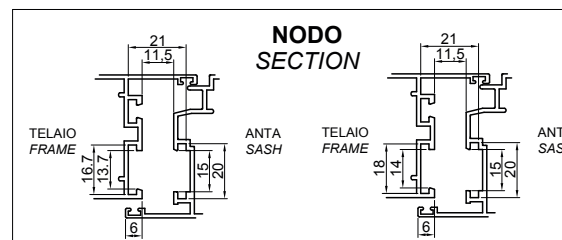
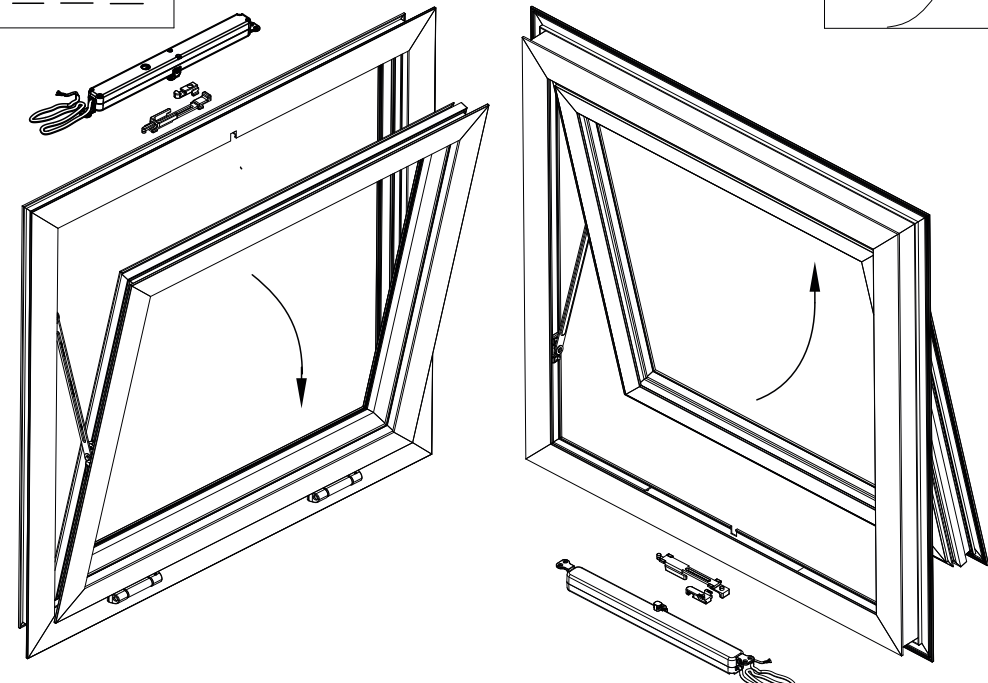
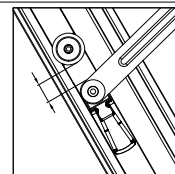

**ATTENZIONE WARNING**

**NON USARE CON SPINTA VERTICALE**  
**DON'T USE WITH VERTICAL LIFT**

Istruzioni di montaggio / Mounting Instructions

TELAIO  
FRAME

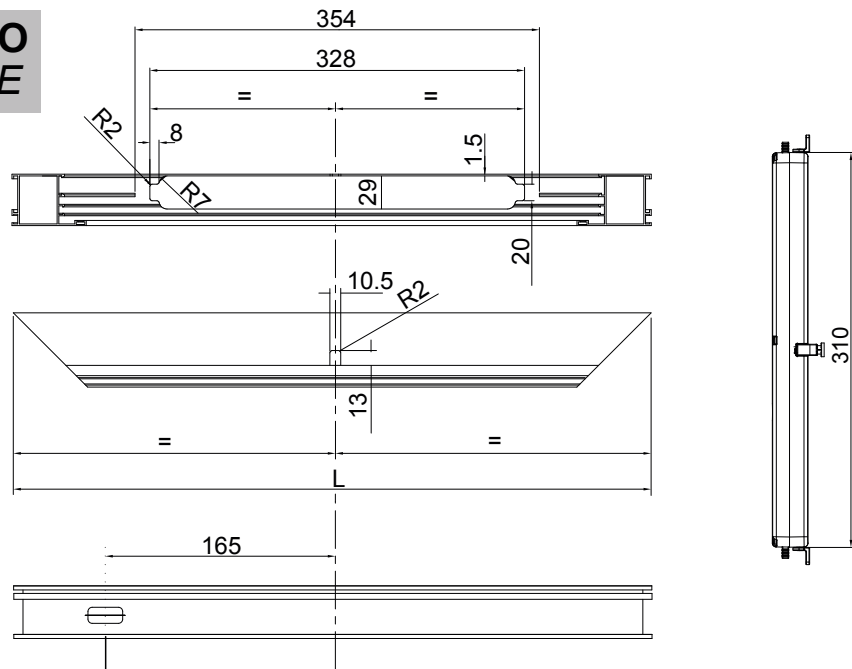

13mm x 26mm

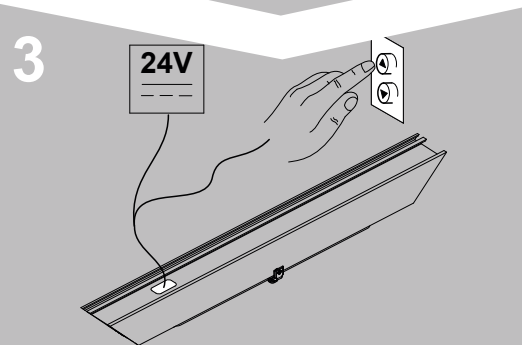
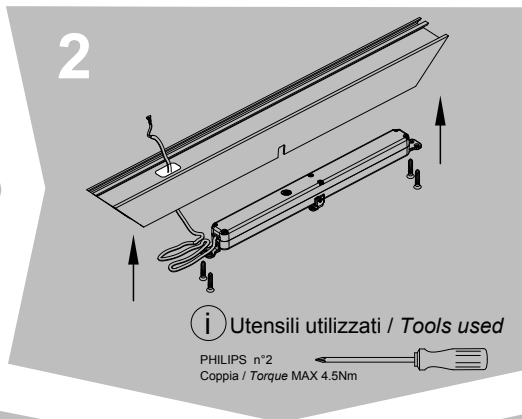
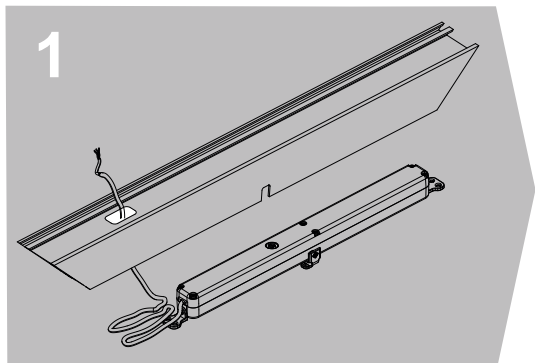

ANTA  
SASH

